



Virtus Two Point Mortice Lock



The Schlage Virtus Two Point mortice lock is a reliable locking solution for residential aluminium or timber doors. Proudly designed and developed in New Zealand, the Schlage Virtus two point lock is a secure solution, offering a locking latch and deadbolt with 13mm and 22mm throw, without the requirement for lock adjustment. The Schlage Virtus lock utilises high strength stainless steel internal components to provide improved security and extended life, achieving S8 (Security) and D8 (durability) ratings in accordance with AS4145:2008.2. The Schlage Virtus lock is compatible with standard fixed cam euro cylinders.

Features

- Provides two points of locking: latch and deadbolt
- Deadbolt can be used in 13 or 22mm throw configurations without needing adjustment
- Deadbolt returns from both 13mm and 22mm states with one turn of the cylinder
- 30mm, 40mm, and 60mm backset options
- Easily orientate the latch to fit right hand or left handed doors
- Adjustable latch projection helps to accommodate larger door gaps
- Latch can be retracted by key/cylinder turn
- Compatible with standard Euro cylinders
- Employs the same door preparation as the Schlage Virtus Four Point Lock

Warranties

Mechanical	10 years
Finish	allegion.co.nz/finisheswarranty

Specifications

Door type	Timber or aluminium						
Door thickness	Minimum 40mm (max dependent upon furniture fixings and spindle length)						
Backset	30mm, 40mm or 60mm						
Spindle size	8mm						
Lock case material	Zinc die-cast						
Forend	Stainless steel, square edged						
Cylinder*	Suits fixed cam Euro profile cylinders, available separately						
Lever furniture	Can be used with Schlage 1000 Series long plate furniture or turn set						
Strike	Range of timber strikes and rebate kit available, for aluminium frame strikes, refer to frame manufacturer						
Product codes	30mm backset: 2PT-30S		40mm backset: 2PT-40S		60mm backset: 2PT-60S		
Timber strike and rebate kit product codes	Door thickness	44mm		58mm		65mm	
	Handing	Left Hand	Right hand	Left hand	Right hand	Left hand	Right hand
	Strikes + dust box	2PT-TSK44L	2PT-TSK44R	2PT-TSK58L	2PT-TSK58R	2PT-TSK65L	2PT-TSK65R
	Rebate kits	2PT-TRK44L	2PT-TRK44R	2PT-TRK58L	2PT-TRK58R	2PT-TRK65L	2PT-TRK65R

*Refer to Allegion price guide for compatible euro cylinder range

Top view



End view

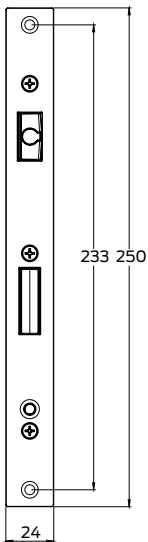

Side view 30mm backset

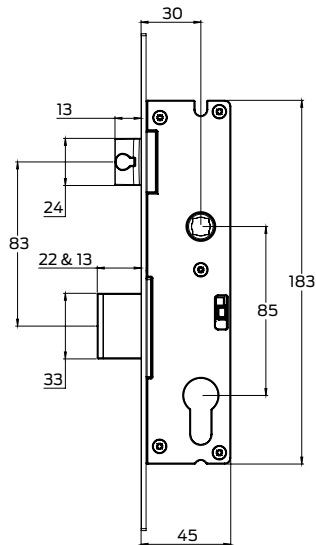

Side view 40mm backset

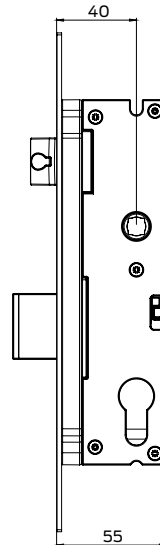

Side view 60mm backset

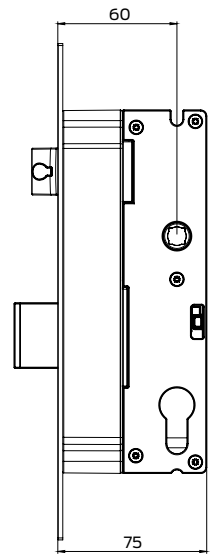

Timber strike

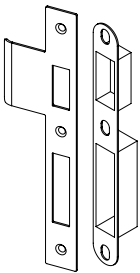

Rebate kit

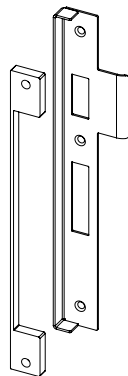

Door preparation details

Aluminium door example shown

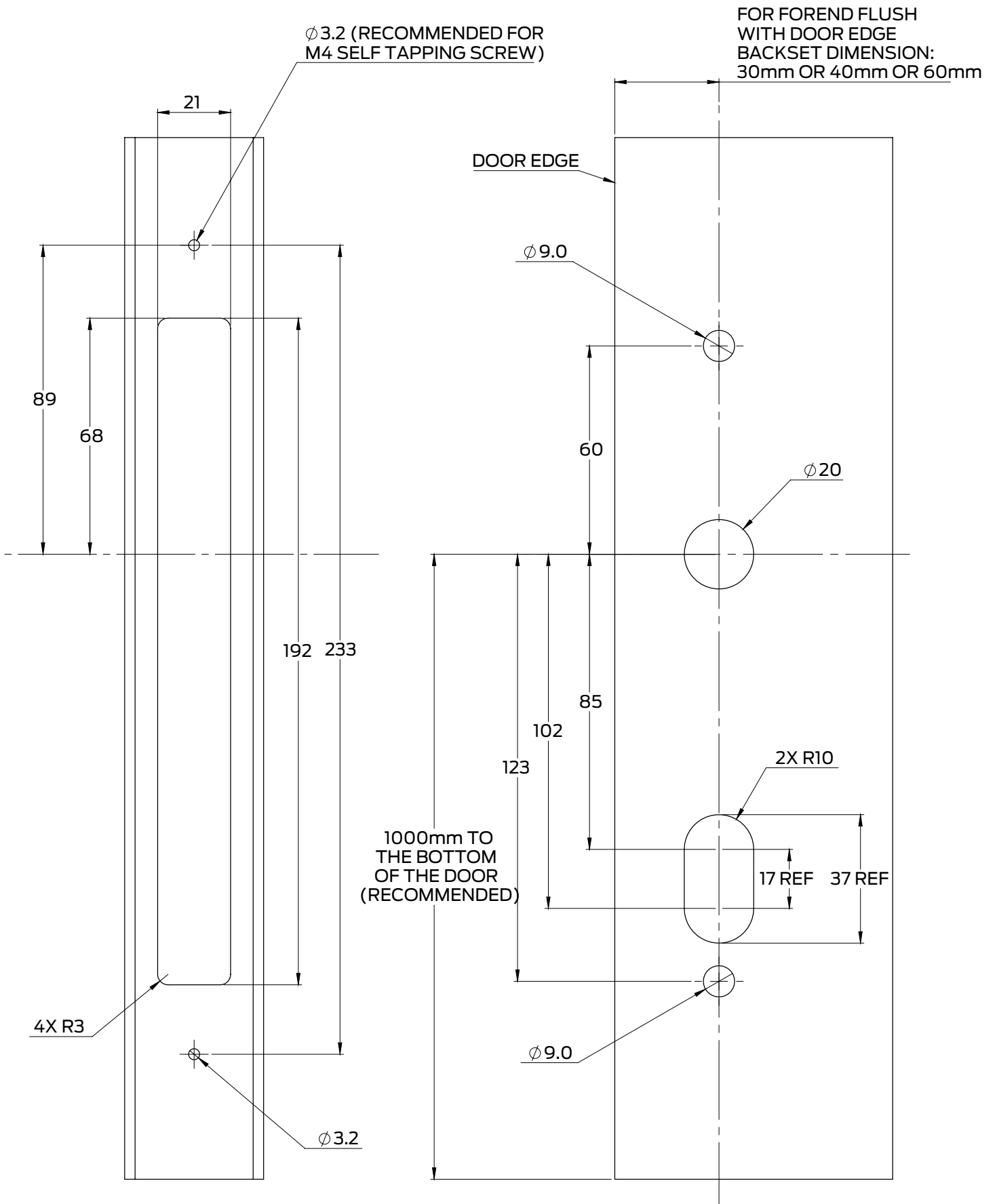

Drawings shown are not to scale.
Technical scale drawings available on request.

© Allegion 2023. All rights reserved. Material and design specifications subject to change without notice. Product colour reproduction is as near to actual product colour as production methods allow. Warning: Products in this brochure are the subject of registered designs and patents. This brochure relates to Australian and New Zealand products only and some product, design or specifications may differ in other countries.